

Project: March 15, 2018 8:30:07 AM by John Salway

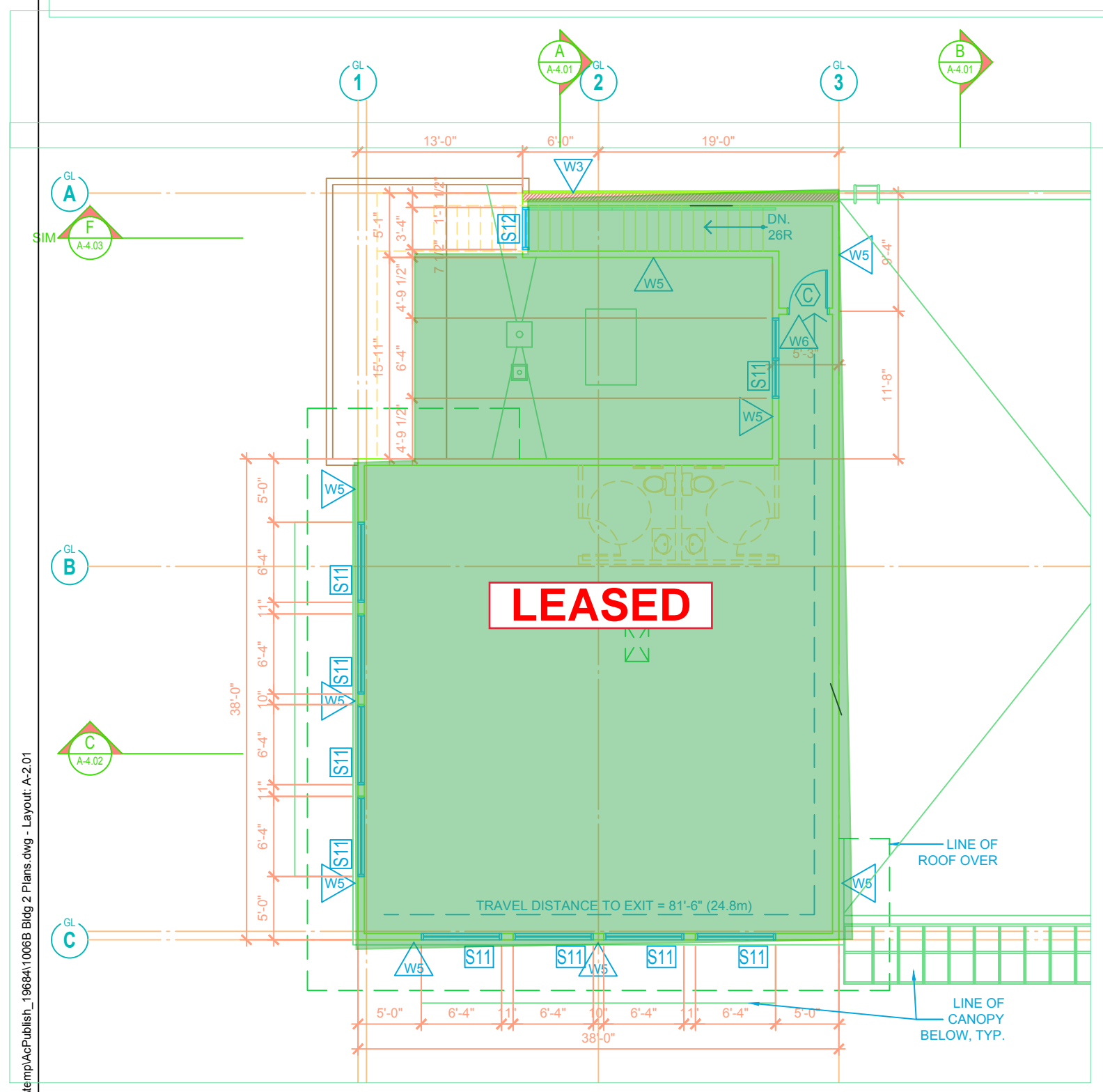

UPPER FLOOR : 1512 sf / 140.46 sm
SCALE: 3/32" = 1'-0"
NORTH

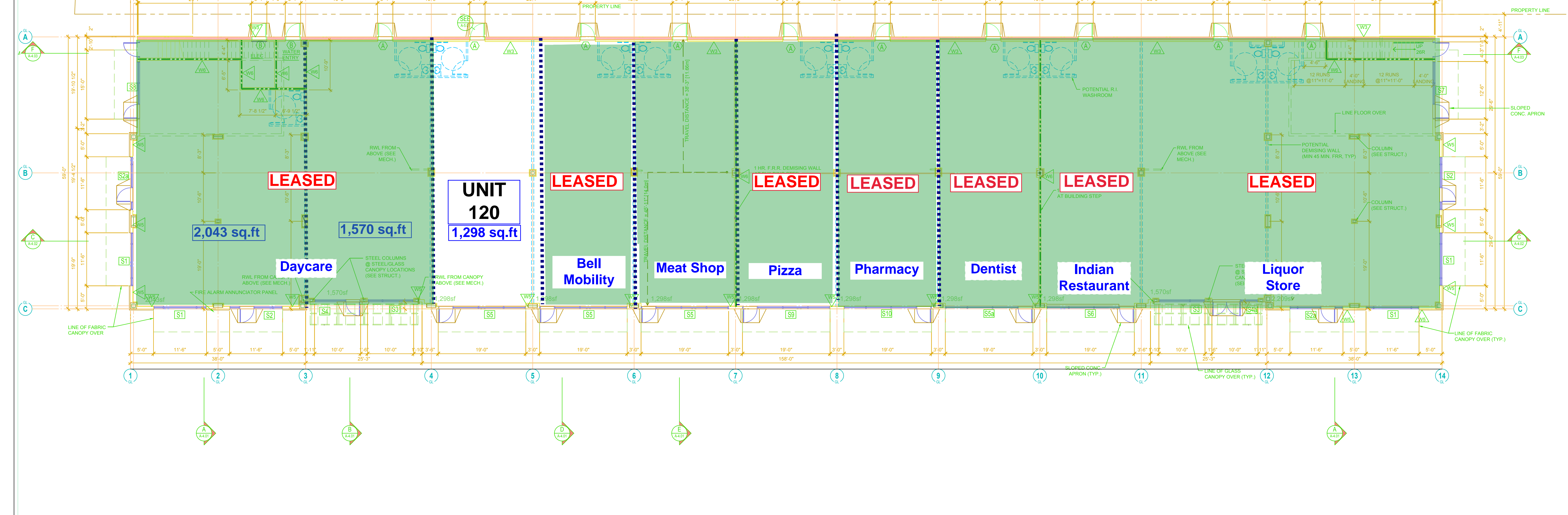
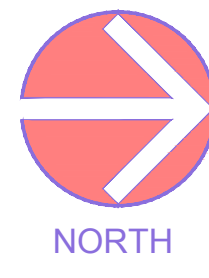

FIRST FLOOR - FLOOR AREA: 16,636sf / 1545.53sm
SCALE: 3/32" = 1'-0"
NORTH

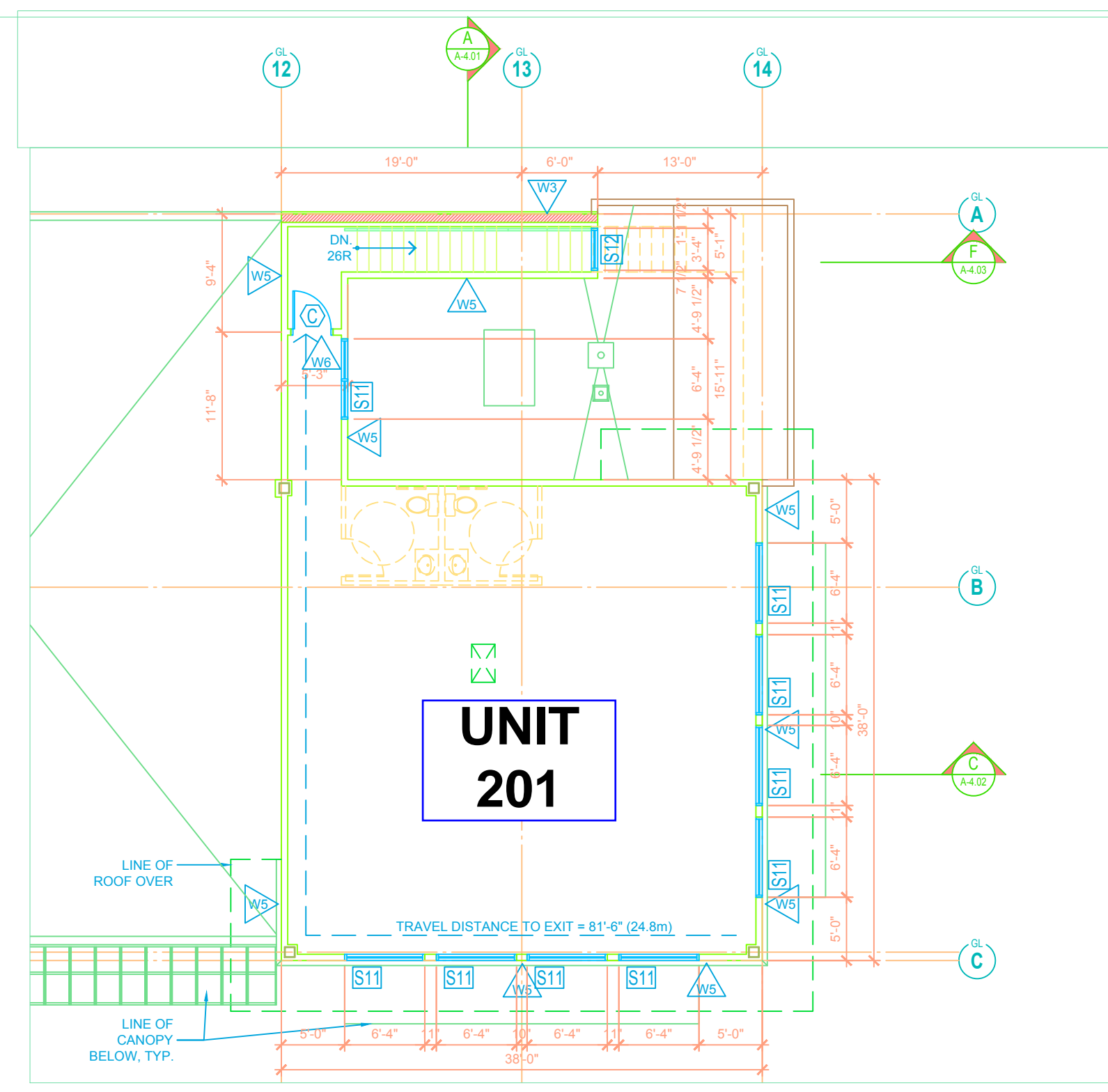

UPPER FLOOR : 1512 sf / 140.46 sm
SCALE: 3/32" = 1'-0"
NORTH

- GENERAL SYMBOL LEGEND**
- CROSS SECTION MARKER
 - SECTION IDENTIFICATION
 - DIRECTION OF VIEW
 - SHEET WHERE DRAWN
 - DETAIL REFERENCE
 - DETAIL NUMBER
 - SHEET WHERE DRAWN
 - 3/4 HOUR FIRE SEPARATION
 - 1 HOUR FIRE SEPARATION
 - ATTIC FIRESTOP
 - WALL CONSTRUCTION TYPE (SEE LEGEND ON A-0.02)
 - FLOOR DRAIN
 - AREA OF LOW CEILING MIN. 7'-0" ABOVE FINISH FLOOR
 - ATTIC ACCESS HATCH TYP. 22x36 OPENING
 - NOTE: SEE SHEET A-0.01 FOR ABBREVIATIONS

©Copyright reserved. This drawing is the property of Focus Architecture Incorporated and may not be duplicated in any way without their express written permission.

FOCUS
ARCHITECTURE
INCORPORATED
Suite 109 - 1528 McCallum Road
Abbotsford, British Columbia V2S 8A3
t 604.853.5442
e info@focus.ca

NOT FOR CONSTRUCTION

| | |
|-------------------|-----------------------------|
| October 02, 2017 | Development Permit Revision |
| November 23, 2016 | General Co-ordination |
| October 26, 2016 | Revised for Building Permit |
| August 17, 2016 | Issued for Building Permit |
| December 15, 2015 | Bldg 2 reconfigured |
| May 01, 2013 | Planning Revisions |
| June 13, 2012 | Issued for Rezoning & DP |
| REVISIONS | |
| CONSULTANT | |

CLIENT
Blue Star Motel (1999) Inc.

PROJECT
PROPOSED COMMERCIAL DEVELOPMENT
28060 Fraser Hwy &
2978 Lefevre Rd. Abbotsford, BC
DRAWING TITLE

BUILDING 2 FIRST FLOOR PLAN

DATE: 2014.05.27 FILE NO.
DWN: hk / al
CHK: CH **1006B**

SEAL SHEET NO.
BUILDING 2 A-2.01

